

MINOLTA

The essentials of imaging

www.minolta.com

DYNAX 4
DYNAX 3
MAXXUM 4

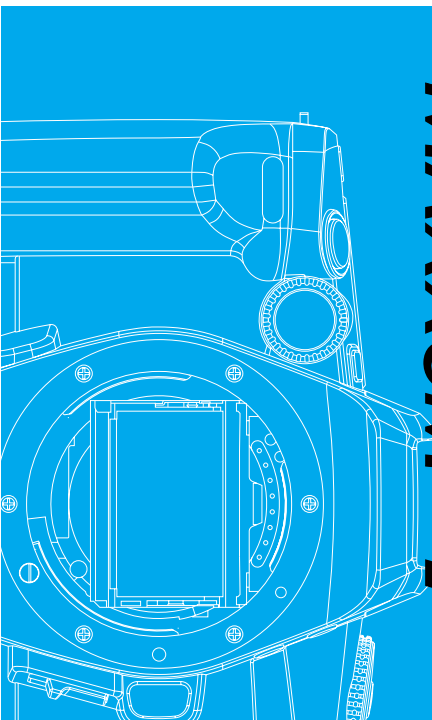

E INSTRUCTION MANUAL

APPENDIX

CUSTOM
FUNCTIONS

DETAILED
OPERATION

CREATIVE
EXPOSURE

SUBJECT /
DRIVE

AUTOMATIC
OPERATION

GETTING
STARTED

TABLE OF CONTENTS

The **GETTING STARTED** section describes how to prepare the camera for use. The **FULLY-AUTOMATIC OPERATION** chapter shows how to take photographs quickly and simply by using the camera's automatic features. Advanced shooting features are covered in **SUBJECT PROGRAM / DRIVE MODES**. The **CREATIVE EXPOSURE MODE** section introduces exposure control. The **DETAILED OPERATION** section describes advanced functions within the camera. The last section, **CUSTOM FUNCTIONS**, shows how to customize camera operation. Custom Function Notes have been inserted throughout the manual as reference to camera operations that can be changed.

FOR PROPER AND SAFE USE	7
QUICK OPERATION	10
NAMES OF PARTS	12
Body	12
Data Panel	14
Viewfinder.....	15

GETTING STARTED

GETTING STARTED	
STRAP	17
Attaching the Strap	17
Using the Eyepiece Cap	18
BATTERIES	19
Installing the Batteries	19
Battery Condition Indicators.....	20
Changing the Batteries - Quartz-date model	21
LENS	22
Attaching the Lens	22
Removing the Lens	22
FILM	23
Loading the Film	23
Film Chamber Lock	25
Rewinding the Film	26
Manual Rewind	26

AUTOMATIC OPERATION

FULLY-AUTOMATIC OPERATION	
HANDLING THE CAMERA	28
Pressing the Shutter-release Button	28
Holding the Camera	28
AUDIO SIGNAL	29
TAKING PICTURES IN FULL-AUTO	30
FOCUS	32
Focus Signals.....	32
Special Focus Situations	33
FOCUS LOCK	34
USING THE BUILT-IN FLASH	35
Flash Signals	35
Flash Range.....	36
Lens Shadowing.....	36
⚡ Fill Flash	37
🔄 Flash Cancel	37
👁 Red-eye Reduction	38

SUBJECT / DRIVE

SUBJECT PROGRAM / DRIVE MODES	
SUBJECT PROGRAM SELECTION	40
👤 Portrait	40
🏞 Landscape	41
📷 Close-up.....	42
🏃 Sports.....	43
🌃 Night Portrait	44
🌃 Photographing Night Scenes	45
DRIVE MODES	46
🕒 Self-timer	46
📄 Continuous Advance	48
🔗 For Owners of the Remote-control Function	49
🔗 Focus Lock in Remote Control Mode	50

GETTING STARTED

AUTOMATIC OPERATION

SUBJECT / DRIVE

CREATIVE EXPOSURE

DETAILED OPERATION

CUSTOM FUNCTIONS

APPENDIX

TABLE OF CONTENTS

CREATIVE EXPOSURE

CREATIVE EXPOSURE MODES	
APERTURE CONTROL	52
SHUTTER CONTROL	53
EXPOSURE MODES	54
A MODE (APERTURE PRIORITY)	55
Flash With A Mode	57
S MODE (SHUTTER PRIORITY)	58
Flash With S Mode	59
M MODE (MANUAL)	60
Metering in Manual Mode	61
Flash With M Mode	62
P MODE	63
PA mode	63
Ps mode	64
EXPOSURE WARNINGS	65

DETAILED OPERATION

DETAILED OPERATION	
FOCUS AREA	67
Wide Focus Area	67
Spot Focus Area	68
Local Focus Areas	69
Focus Area Selection controls	70
FOCUS MODES	71
Δ Automatic AF	71
\odot Continuous AF	72
\square Single-shot AF	73
MF Manual Focus	74
AF ILLUMINATOR	75
EXPOSURE	76
14-Segment Honeycomb Pattern Metering	76
Spot Metering	76
\blacksquare Spot-AE Lock	77
TAKING TIME EXPOSURES (buLb)	79
EXPOSURE COMPENSATION	82
Checking Exposure Compensation	83

DETAILED OPERATION

DETAILED OPERATION	
SETTING THE ISO MANUALLY	84
EXPOSURE BRACKETING	85
Continuous Advance Bracketing	86
Single Frame Advance Bracketing	86
Flash Notes	87
Bracketing with the Exposure-compensation Button ..	87
MULTIPLE EXPOSURE	88
Metering Multiple Exposure	90
FLASH	91
Program Flash	91
Attaching the Program Flash	92
Flash Metering	92
SLOW-SYNC	94
WIRELESS/REMOTE FLASH	95
Setting Wireless/Remote Flash Mode	96
Taking Pictures in Wireless/Remote Flash Mode	97
FOR OWNER'S OF THE QUARTZ DATE MODEL	100
Setting the Date or Time	100
Imprinting the Date or Time	101
Changing the Date Format	102

CUSTOM FUNCTIONS

CUSTOM FUNCTIONS	103
-------------------------------	-----

APPENDIX

APPENDIX	112
PROGRAM-RESET BUTTON	113
ACCESSORY INFORMATION	114
TROUBLE SHOOTING	118
CARE AND STORE	120
SPECIFICATIONS	122
INDEX	124
MEMO	126

GETTING STARTED

AUTOMATIC OPERATION

SUBJECT / DRIVE

CREATIVE EXPOSURE

DETAILED OPERATION

CUSTOM FUNCTIONS

APPENDIX

FOR PROPER AND SAFE USE

Thank you for purchasing this camera. Please take time to read this manual so that you can enjoy all the features of your new camera. This manual has been designed to help you understand the camera's operation quickly. The information in this manual is relevant for products introduced before May, 2002. Contact the nearest authorized Minolta Service facility to obtain compatibility information for products released after this date.

This camera is designed to work specifically with lenses and accessories manufactured and distributed by Minolta. Using incompatible accessories with this camera may result in unsatisfactory performance or damage the camera and accessories.

This device complies with Part 15 of the FCC Rules. Operation is subject to the following two conditions: (1) This device may not cause harmful interference, and (2) this device must accept any interference received, including interference that may cause undesired operation. Changes or modifications not approved by the party responsible for compliance could void the user's authority to operate the equipment. This equipment has been tested and found to comply with the limits for a Class B digital device, pursuant to Part 15 of the FCC Rules. These limits are designed to provide reasonable protection against harmful interference in a residential installation. This equipment generates, uses and can radiate radio frequency energy and, if not installed and used in accordance with the instructions, may cause harmful interference to radio communications. However, there is no guarantee that interference will not occur in a particular installation. If this equipment does cause harmful interference to radio or television reception, which can be determined by turning the equipment off and on, the user is encouraged to try to correct the interference by one or more of the following measures:

- Reorient or relocate the receiving antenna.
- Increase the separation between the equipment and the receiver.
- Connect the equipment to an outlet on a circuit different from that to which the receiver is connected.
- Consult the dealer or an experienced radio/TV technician for help.

This Class B digital apparatus complies with Canadian ICES-003.



This mark on the bottom of your camera is there to inform you that this camera meets the requirements of the EU (European Union) concerning interference causing equipment regulations. CE stands for Conformité Européenne (European Conformity).

Read and understand all warnings and cautions before using this product.

WARNING

Using batteries improperly can cause them to leak harmful solutions, overheat, or explode which may damage property or cause personal injury. Do not ignore the following warnings.

- Only use the batteries specified in this instruction manual.
- Do not install the batteries with the polarity (+/-) reversed.
- Do not use batteries which show wear or damage.
- Do not expose batteries to fire, high temperatures, water, or moisture.
- Do not attempt to short or disassemble batteries.
- Do not store batteries near or in metallic products.
- Do not mix batteries of different types, brands, or ages.
- Do not use leaking batteries. If fluid from the batteries enters your eye, immediately rinse the eye with plenty of fresh water and contact a doctor. If fluid from the batteries makes contact with your skin or clothing, wash the area thoroughly with water.
- Tape over lithium battery contacts to avoid short-circuiting during disposal; always follow local regulations for battery disposal.
- Do not disassemble this product. Electric shock may cause injury if a high voltage circuit inside the product is touched. Take the product to a Minolta Service Facility when repairs are required.

FOR PROPER AND SAFE USE

WARNING

- Immediately remove the batteries and discontinue use if the camera is dropped or subjected to an impact in which the interior, especially the flash unit, is exposed. The flash has a high voltage circuit which may cause an electric shock resulting in injury. The continued use of a damaged product or part may cause injuries.
- Keep batteries or small parts that could be swallowed away from infants. Contact a doctor immediately if an object is swallowed.
- Store this product out of reach of children. Be careful when around children, not to harm them with the product or parts.
- Do not fire the flash directly into the eyes. It may damage eyesight.
- Do not fire the flash at vehicle operators. It may cause a distraction or temporary blindness which may lead to an accident.
- Do not look at the sun or strong light sources directly through the viewfinder or lens. It may damage your eyesight or cause blindness.
- Do not expose this product to liquids or operate this product with wet hands. If liquid enters the product, immediately remove the batteries and discontinue use. The continued use of a product exposed to liquids may cause damage or injury through fire or electric shock.
- Do not use the product near inflammable gases or liquids such as gasoline, benzine, or paint thinner. Do not use inflammable products such as alcohol, benzine, or paint thinner to clean the product. The use of inflammable cleaners and solvents may cause an explosion or fire.
- If the product emits a strange odor, heat, or smoke, discontinue use. Immediately remove the batteries taking care not to burn yourself. The continued use of a damaged product or part may cause injuries.
- Take the product to a Minolta Service Facility when repairs are required.

CAUTION

- Do not point the product directly at the sun. If sunlight is focused on an inflammable surface, a fire may result. Replace the lens cap when the product is not in use.
- Do not use or store the product in a hot or humid environment such as the glove compartment or trunk of a car. It may damage the product and batteries which may result in burns or injuries caused by heat, fire, explosion, or leaking battery fluid.
- If batteries are leaking, discontinue use of the product.
- Do not fire the flash while it is in contact with people or objects. The flash unit discharges a large amount of energy which may cause burns.
- Do not apply pressure to the data panel. A damaged panel may cause injury, and the liquid from the panel may cause inflammation. If liquid from the panel makes contact with skin wash the area with fresh water. If liquid from the panel comes in contact with the eyes, immediately rinse the eyes with plenty of water and contact a doctor.

QUICK OPERATION

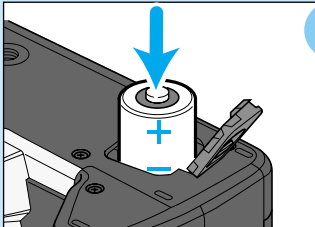

- 1 Insert batteries.**
- This camera uses two CR2 lithium batteries. [p.19](#)

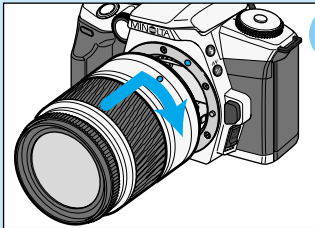

- 2 Attach the lens.**
- Align the red mounting index on the lens with the one on the camera. Carefully insert the lens into the mount and turn it clockwise until it clicks into the locked position. [p.22](#)

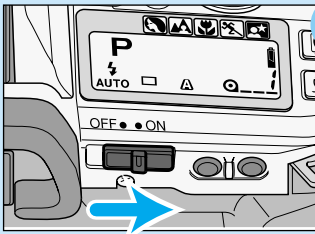

- 3 Slide the main switch to ON.**

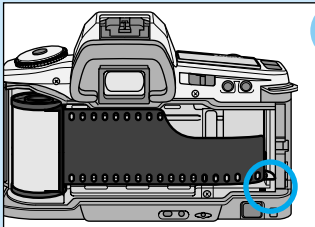

- 4 Load the film.**
- Align the film tip with the red mark, then close the back cover. [p.23](#)

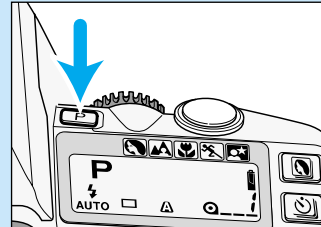

- 5 Set full-auto operation.**
- Press the program-reset button to set the camera to fully automatic operation. [p.30](#)

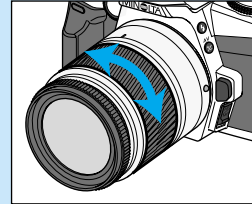

- 6 Center your subject in the wide focus frame []. If using a zoom lens, rotate the zooming ring to frame your subject as desired.**

- The camera will focus and set exposure automatically when the shutter release button is pressed partway down. [p.28](#)
- The audio signal confirms the camera has focused when the shutter release button is pressed partway down. [p.29](#)

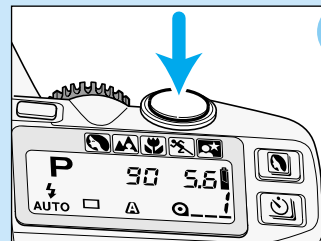

- 7 When ● or ● appears in the viewfinder, press the shutter-release button all the way down to take the picture.**
- Use focus lock if your subject is off-center and outside the focus frame. [p.32](#)

NAMES OF PARTS

Body

For information on specific parts, refer to the page shown in parentheses.

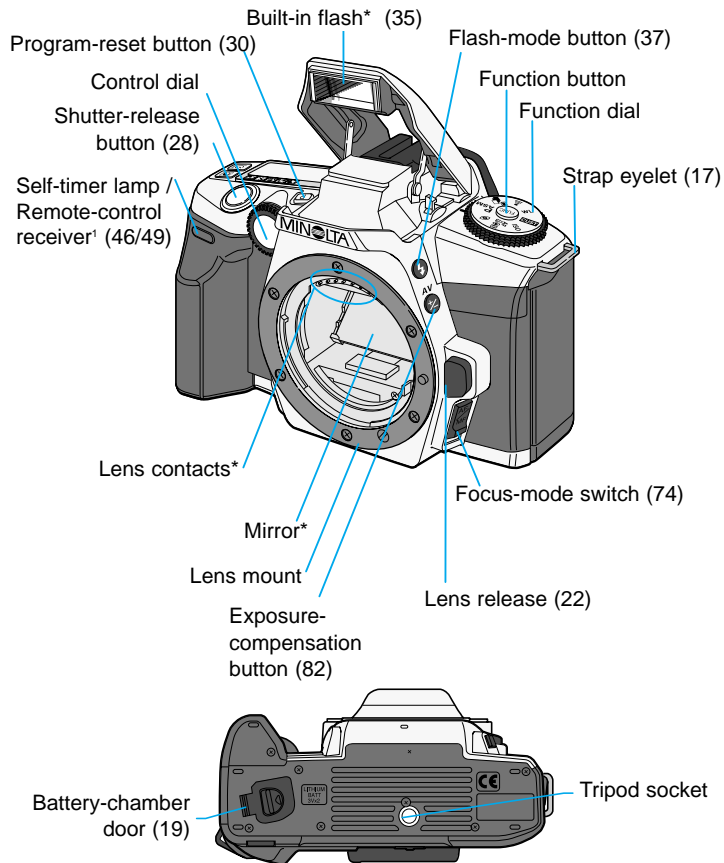

***This camera is a sophisticated optical instrument. Care should be taken to keep these surfaces clean. Please read the care and storage instructions in the back of this manual (p. 122).**

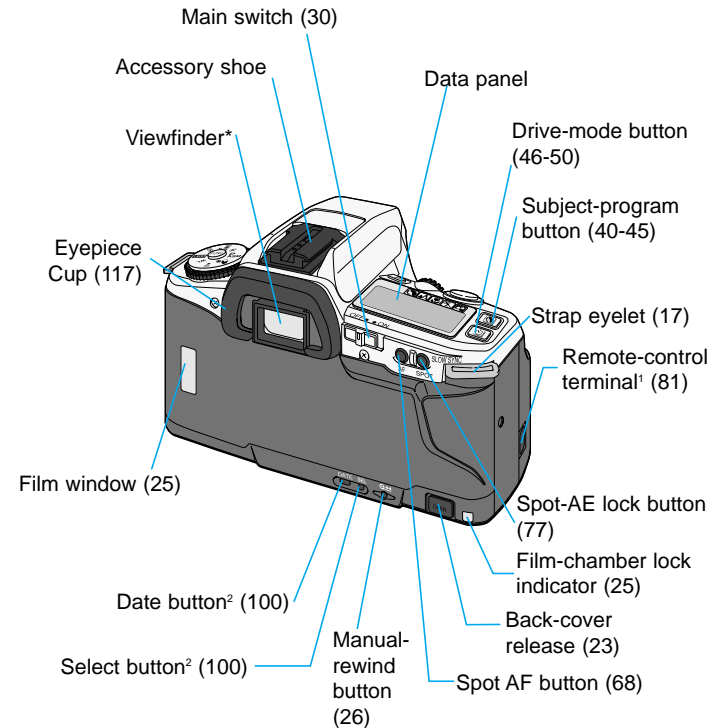

¹Available on the remote-control model only.

²Available on the quartz-date model only.

The quartz-date model is equipped with remote-control function.

NAMES OF PARTS

Data Panel

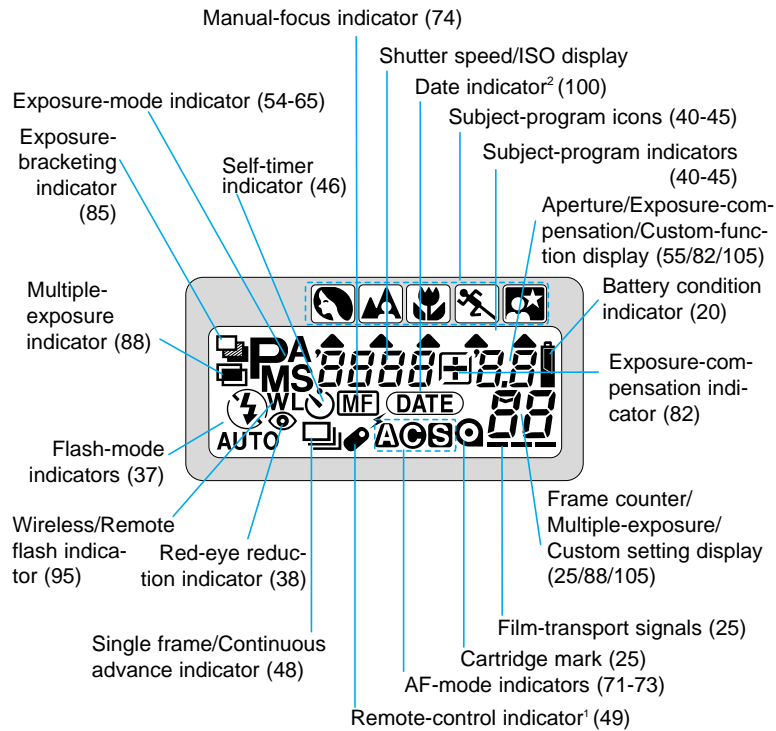

¹Available on the remote-control model only.

²Available on the quartz-date model only.

The quartz-date model is equipped with a remote-control function.

Viewfinder

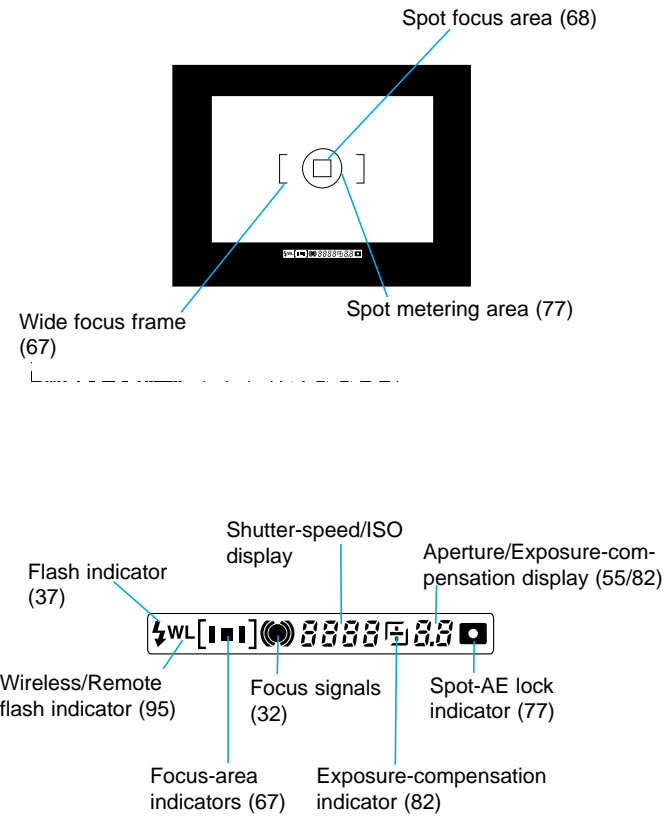

GETTING STARTED

This section provides the information necessary to prepare the camera for use.

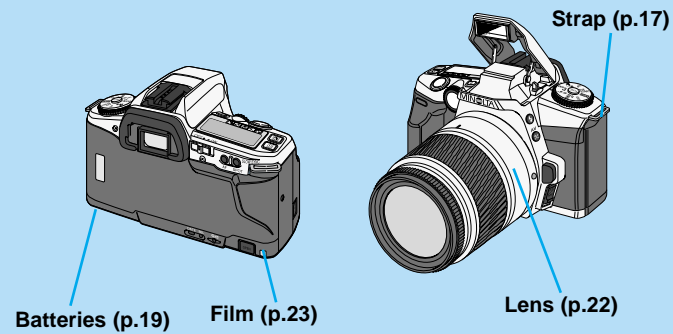

STRAP

Attaching the Strap

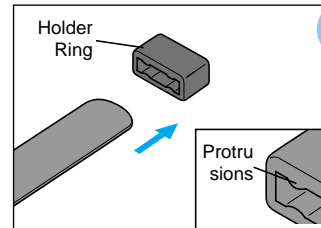

1 With the visible protrusions on the inside of the holder ring oriented as shown, pass the tip of the strap through the ring.

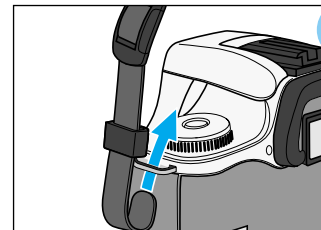

2 Pass the tip of the strap through the camera's strap eyelet from below.

- Attach the strap so the tip comes between the strap and the camera.

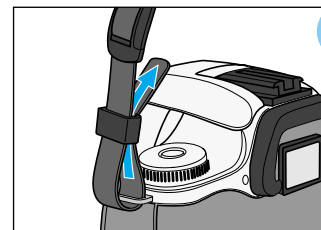

3 Pass the tip of the strap through the holder ring.

- Use the following method if the ring is tight for the tip.
 - 1) Fold the strap, and slide the holder ring over the tip.
 - 2) Hold the strap, and slide the holder ring in the direction shown.

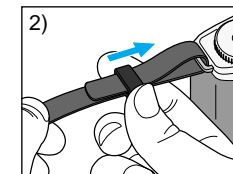
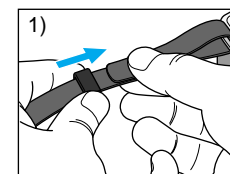

STRAP

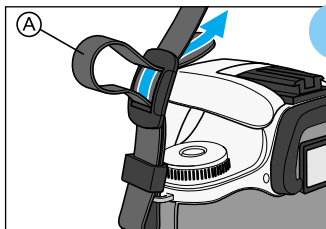

4 Pass the tip of the strap through the buckle and pull to tighten.

- Leave some slack in the camera strap(A) so the tip may be threaded through the buckle easily.

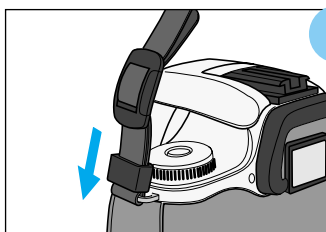

5 Push the holder ring toward the strap eyelet to secure the strap to the camera.

- Repeat with the other end of the camera strap.

- Take care not to catch the strap when closing the back cover.

Using the Eyepiece Cap

The eyepiece cap is used to prevent light from entering the camera during time exposures (buLb, p. 79) or when using the self-timer (p. 46). Light entering through the viewfinder can affect the metered exposure.

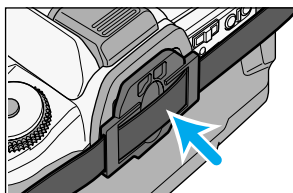

Firmly press the eyepiece cap of the strap into the eyepiece.

BATTERIES

Installing the Batteries

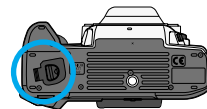

Your camera uses two 3V CR2 lithium batteries to supply power for all camera operations.

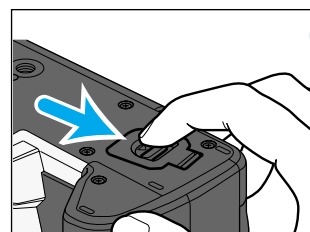

1 Slide the battery-chamber release as shown, and open the door.

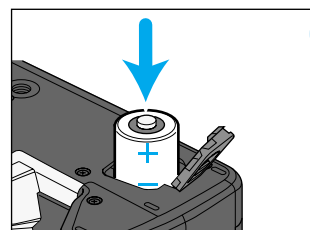

2 Insert the batteries. Match the positive terminal mark inside the battery chamber-door with the positive end of the batteries.

3 Close the battery-chamber door and push until it clicks.

- When changing batteries, make sure the main switch is off.
- Setting the camera down with the battery-chamber door open may damage the camera.
- For owners of the quartz-date model, The clock and calendar are powered by the camera's batteries. If the batteries are removed, and the date and time will reset, date imprinting function will be disabled. To store the date and time when changing batteries, see page 21.
- Read "FOR PROPER AND SAFE USE" (p.7) before using batteries.

BATTERIES

Battery Condition Indicators

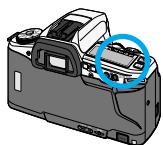

Battery condition indicators shows the level of battery power.

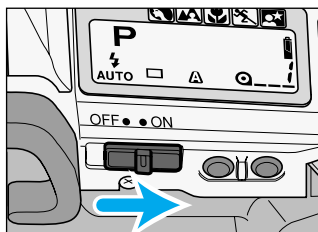

Turn the main switch to ON.

- A battery icon appears on the data panel indicating the power status of the batteries.
- For owners of the quartz-date model, the date settings will blink if not set. Set the date settings (p.100) or press the program-reset button to display the power status.

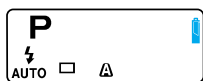

Steady

- Power is sufficient for all camera operations.

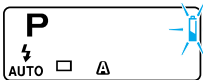

Blinks

- Power is low. All functions are operational, but the batteries will need to be replaced soon. Flash recycling time may be slow.

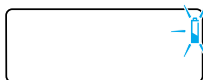

Blinks (no other displays appear)

- Power is insufficient for camera operation and the shutter is locked. Replace the batteries.

- If the data panel is blank, the batteries may be dead or installed incorrectly.

- Occasionally, the battery-condition indicator will give a false low-battery-power warning  , even though there is enough power capacity. Turn the main switch on and off a few times to reset the display.

Changing the Batteries - Quartz-date Model

When the batteries have been removed, the camera's built-in clock will stop. The following procedure stores the current time and date in case the clock and calendar reset when the batteries are removed.

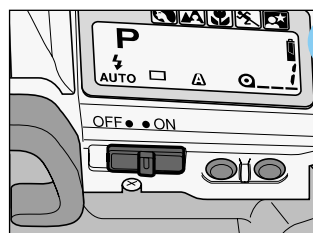

1 Turn the camera on and off.

- The camera stores the current date and time in a memory register each time the camera is turned off or on.

2 Change the batteries as described on page 19. Turn the camera on.

- Either of the following display appears on the data panel.

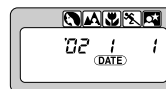

- If normal display appears on the data panel, the clock and calendar did not reset and the camera can be used. Step 3 and 4 are not necessary.

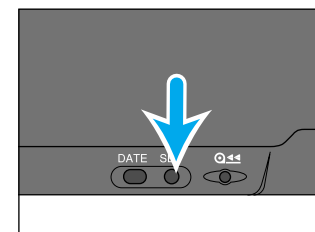
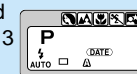

3 Press the select button.

- The stored date and time settings will appear on the display.

4 Reset the clock if necessary.

- Refer to the page 100 for detailed instructions.

LENS

Attaching the Lens

This camera uses interchangeable lenses. See page 114 for information on which lenses are compatible with this camera.

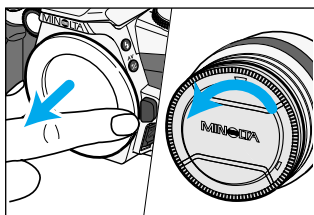

- 1 Remove the body and rear lens caps.

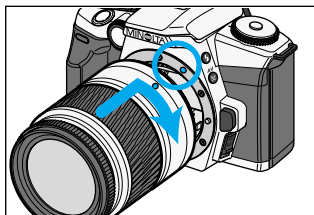

- 2 Align the red mounting index on the lens and camera body. Carefully insert the lens into the mount, then turn it clockwise until it clicks into the locked position.

- Do not insert the lens at an angle.

Removing the Lens

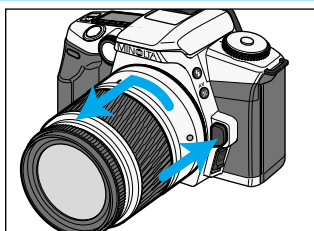

While pressing the lens release, turn the lens counter-clockwise until it stops. Carefully remove the lens.

- Replace the caps on the lens and attach the body cap or another lens on the camera.

- Never force the lens. If it does not fit, check its orientation with the index marks. When removing, make sure the lens release is pressed all the way down.
- Do not touch the inside of the camera, especially the lens contacts and mirror.

FILM

Always load or remove the film under subdued light to reduce the chances of fogging.

Loading the Film

The camera automatically sets the correct film speed (ISO) with DX-code film.

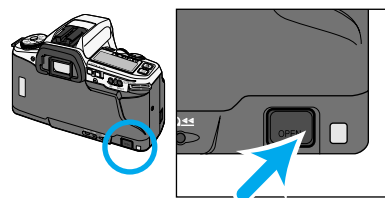
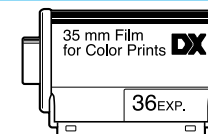

- 1 Press the back-cover release to open the back cover.

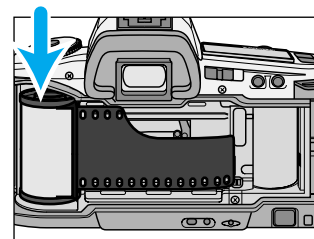

- 2 Insert the film cartridge into the film chamber.

- Do not use Polaroid Instant 35mm film. Winding problems may occur.
- Do not use infrared film in this camera. The camera's frame counter sensor will fog infrared film.
- If non-DX-coded film is used, the camera will use the previous roll's ISO setting. Refer to page 84 to set the film speed manually.
- More than 40 exposures can not be taken on one roll with this camera. When using 72-exposure film, the camera will start to rewind the film after 40 exposures have been made.

Continued on next page

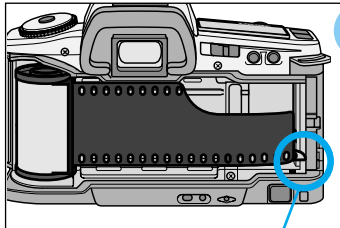

3 Extend the leader between the guide rails to the index mark.

- Hold the film cartridge down so that the film lays flat.
- If the film tip extends beyond the index mark, take the cartridge out and rewind the excess film back into the cartridge.

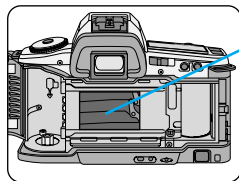
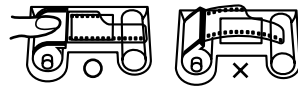
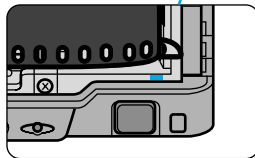

The shutter curtain's precision design makes it extremely sensitive to pressure. Never touch it with your fingers or the film tip.

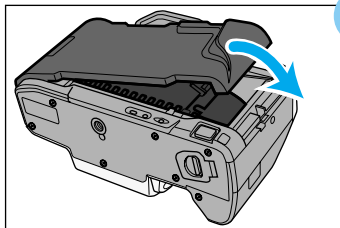

4 Close the back cover.

- The camera automatically advances the film to the first frame.
- Take care not to catch the strap when closing the back cover.



When the film is loaded correctly :

- ∞ appears in the frame counter. The film speed (ISO) is displayed on the data panel for 5 seconds.
- If the film is loaded with the power off, the film speed (ISO) and ∞ appears on the data panel for approximately five seconds to indicate successful loading, then the camera shuts down.



When the film is loaded incorrectly :

- ∞ blinks in the frame counter and the shutter locks. Open the back cover and repeat steps 2 - 4.
- If the film is loaded with the power off, ∞ blinks on the data panel before the camera shuts down.

Film-chamber Lock

Once the film is loaded, the back-cover release will lock until the film is rewound to prevent the camera from being opened accidentally.

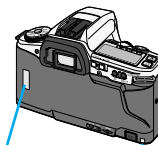

The film window and the film-chamber lock indicator will show if a roll of film is in the camera. Always check these before loading a new film.

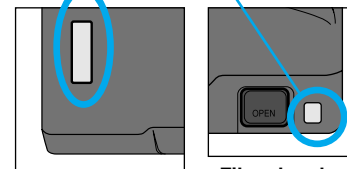

Film Window

Film-chamber lock indicator

- When film is loaded properly, the film chamber lock indicator is red, and the back cover cannot be opened.
- To change a roll of film in the camera, refer to manual rewind on page 26.

FILM

Rewinding the Film

After you have exposed the last frame, the camera will automatically rewind the film.

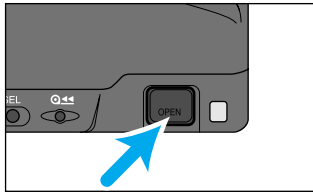

- 1 Wait until the film is completely rewound.**
 - will appear and will blink on the data panel, indicating it is safe to open the back-cover.
 - The film-chamber lock indicator is blank after the film is rewound.

- 2 Press the back-cover release to open the back cover and remove the film, then close the back cover.**

- Do not turn the focusing ring when the film is rewinding.
- Although more pictures than specified on the film package may be taken, the film processor may not print more than the number specified on the film cartridge.

Manual Rewind

Use manual rewind to rewind the film before the roll is finished.

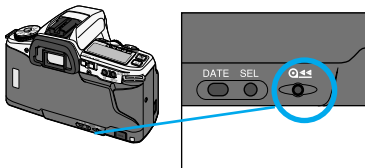

- Gently press the manual-rewind button using a pen.**
- Only use blunt objects. Sharp objects may damage the camera.
 - will appear and will blink on the data panel when the film has rewound.

Custom Function Notes

- Cust-2: Automatic (1) or manually initiated (2) rewind start (p.106).
- Cust-3: Rewind the leader into the cartridge (1) or leave the leader out (2) (p.107).

FULLY-AUTOMATIC OPERATION

Use full-auto when you are just starting out or when shooting under conditions that would require you to constantly adjust the focus or exposure.

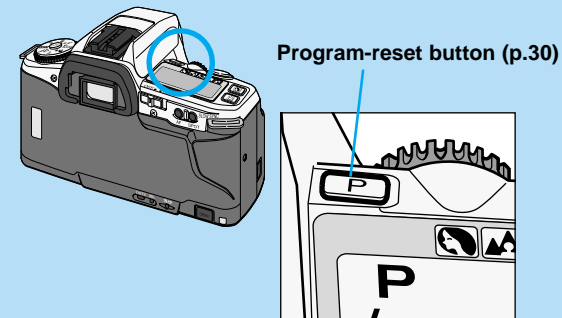

HANDLING THE CAMERA

Pressing the Shutter-release Button

Press the shutter-release button partway down to activate the camera's autofocus and auto-exposure systems. Press the shutter-release button all the way down to take the picture. When taking a picture, press the shutter-release button with your index finger gently so not to shake the camera during the exposure.

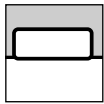

Before pressing

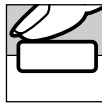

Pressing partway down activates camera systems

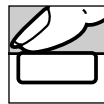

Pressing all the way down releases the shutter

Holding the Camera

Grip the camera firmly with your right hand, while supporting the lens with your left. Keep your elbows at your side and your feet shoulder-width apart to hold the camera steady. Keep the camera strap around your neck or wrist in the event you accidentally drop the camera.

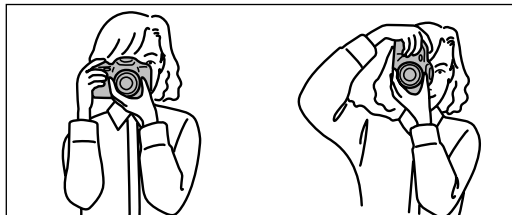

- Lean against a wall or rest your elbows on a solid surface to steady the camera in low-light situations.
- The use of the tripod is recommended when using the camera in low-light situations or with slow shutter speeds or telephoto lenses.

AUDIO SIGNAL

Audio signal is initially on. The camera will produce an audio tone when :

- **focus is confirmed.**
2 short beeps
(Continuous AF (p. 72) does not use audio signals.)
- **during the self-timer countdown.**
will beep in unison with the self-timer lamp.
- **Remote-control operation***
will give one short beep before the shutter releases with the release button.
With the delayed-release button, the signal will beep rapidly for 1 second, and then sound a long tone just before the shutter releases.

*Remote-control is sold separately for owners of the quartz-date model.

AUTOMATIC OPERATION

Canceling the Audio Signal

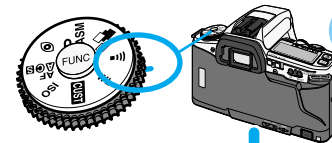

1 Turn the function dial to).

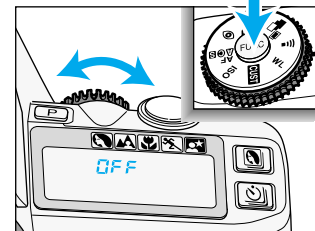

2 While pressing the function button, turn the control dial to .

Turning the Audio Signal On

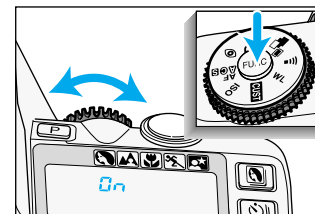

1 Turn the function dial to).

2 While pressing the function button, turn the control dial until appears on the data panel.

TAKING PICTURES IN FULL-AUTO

Full-auto is the camera's standard operating mode and is suited for use in almost any situation. When selected, the camera sets the focus and exposure automatically and fires the built-in flash when necessary.



1 Slide the main switch to ON.

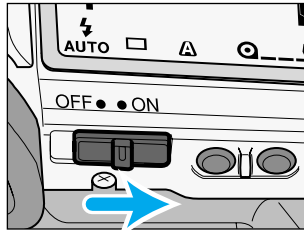

2 Press the program-reset button **P** to set the camera to full-auto.

- The camera will return to its default settings (p113).

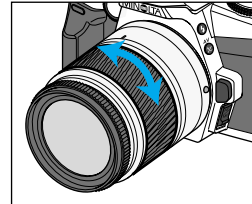
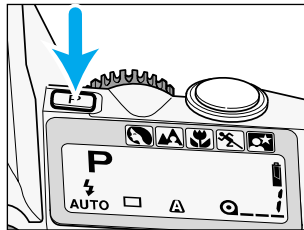

3 Center your subject in the wide focus frame []. If using a zoom lens, rotate the zooming ring to frame your subject as desired.

- Press the shutter release button partway down to activate the autofocus and exposure systems.
- When  appears in the viewfinder, the flash will fire (p.35).



AUTOMATIC OPERATION

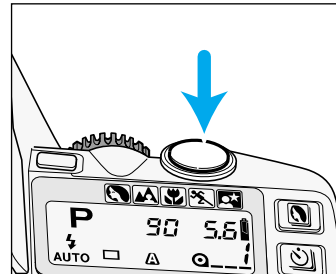

4 When ● or (●) appears in the viewfinder, press the shutter-release button all the way down to take the picture.

- The audio signal confirms the camera has focused when the shutter-release button is pressed partway down.
- In low-light conditions, the AF illuminator will activate to determine focus distance (p.75).

FOCUS

Focus Signals

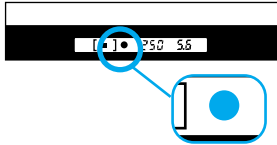

The following signals appear in the viewfinder to indicate the focus status.

- Focusing time can be longer with macro or telephoto lenses. In very dark conditions the camera may require a little more time to ensure accurate focus.

● Steady	Focus is confirmed.
⊙ Steady	Focus is confirmed (Continuous AF).
⊙ Steady	Lens is focusing (Continuous AF). <ul style="list-style-type: none"> • The shutter is locked.
● Blinking	Focus cannot be confirmed. <ul style="list-style-type: none"> • The shutter is locked.

- When focus cannot be confirmed, the subject may be too close or one of the special focus situations on the following page is preventing the system from focusing. Use focus lock (p. 33) or manual focus (p. 74).

Custom Function Notes

Cust-1: Autofocus has priority (1), shutter-release has priority (2) (p.106).

Special Focus Situations

The camera may not be able to focus in the situations described below. Use focus lock (p. 33) or manual focus (p.74).

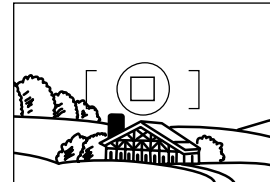

If the subject within the focus frame is very bright, or low in contrast.

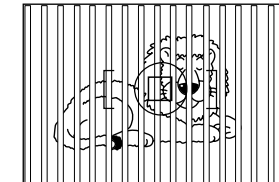

If two subjects at different distances overlap in the focus frame.

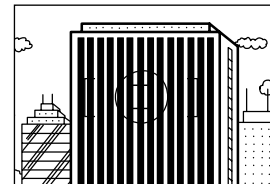

If a subject composed of alternating light and dark lines completely fills the focus frame.

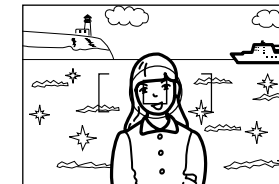

If your subject is near a very bright object or area.

FOCUS LOCK



The focus-lock function is used when the subject is off-center and outside the focus frame. Focus lock may also be used when a special focusing situation prevents the camera from focusing on the subject.

- Focus lock cannot be used with continuous AF. The spot AF button (p.68) can also be used for focus lock.
- Focus can be locked in continuous AF  (p.72) with the spot AF button.



1 Center your subject in the wide focus frame , then press the shutter-release button partway down to lock the focus.

- When  appears in the viewfinder, the focus is locked.
- Focus lock also sets the exposure settings.

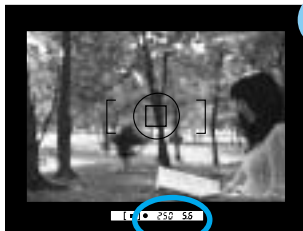

2 Continue to hold the shutter-release button partway down while you compose your picture.



3 Press the shutter-release button the rest of the way down to take the picture.

- Removing your finger off the shutter-release button cancels focus lock.

USING THE BUILT-IN FLASH



In P-mode, the built-in-flash will pop-up automatically when the shutter-release button is pressed partway down. Once the flash is up, it will fire when necessary.

- The shutter will not release until the flash is charged.
- To turn off the autoflash, select flash cancel .
- Pressing the program-reset button resets the flash to autoflash mode.
- Push down the built-in flash when the camera is not in use.

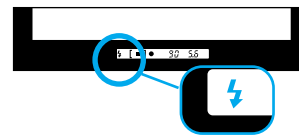
Flash Signals



Flash signals in the viewfinder indicate the status of the flash.

 Steady	Flash is charged and will fire when the shutter-release button is pressed.
 Blinks	Flash output was sufficient to provides correct exposure.

- When  does not blink after taking the picture, the subject was not within the flash range. Please check the flash range on the next page.